



14 Anita Crescent , PORT MACQUARIE



Renovated Appeal ? Quietly Tucked Away Right Near Town Centre

You'll love the lifestyle provided here, being located so central to Port Macquarie's main street and Town Centre. You can stroll to eateries, cafes and entertainment as well as being able to take your morning or afternoon walk through the nature reserve opposite.

Solid and sizeable, this is a home you need to step inside to discover all that is on offer with comfortable renovated interiors and all the outdoor space in the big backyard.

Stunning is the modern kitchen, having a square set bench as the centre piece, trimmed in stone benchtop with an abundance of drawers and an amazing walk-in pantry so large you'll need two trips to Coles to fill it!

Large land area (928sqm) allows you to have this sizeable home and still have plenty of sp

\$595,000

Type: House
Sold Date: 29/08/2018
Land: 928 m2

gregtrembath
REAL ESTATE

Greg Trembath

0412 001 944

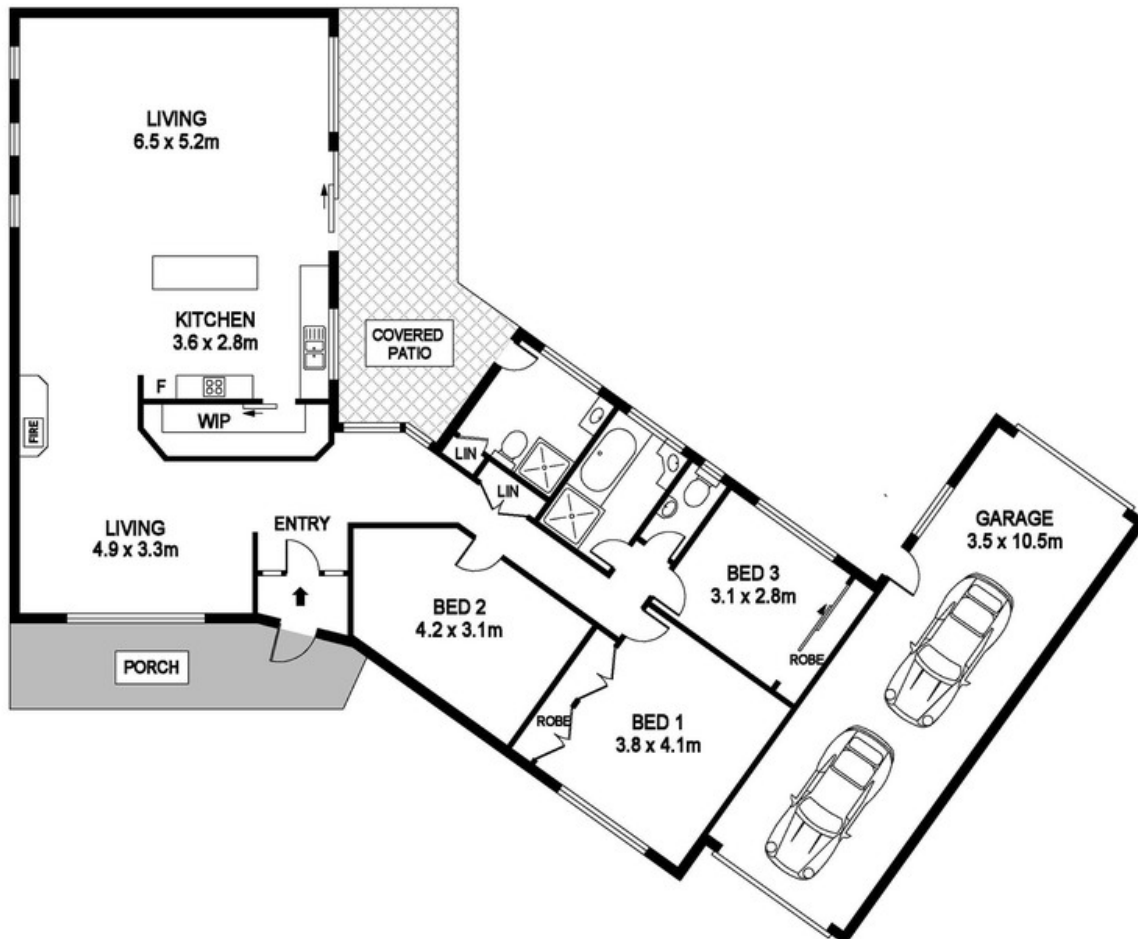

14 Anita Cr, Port Macquarie

DISCLAIMER

PLANS SHOWN ARE FOR MARKETING PURPOSES ONLY. ALL DIMENSIONS ARE APPROXIMATE AND NOT TO SCALE. THEY ARE SUBJECT TO ERRORS AND INACCURACIES AND NO LIABILITY WILL BE ACCEPTED. INTERESTED PARTIES SHOULD MAKE THEIR OWN INQUIRES.